

1

INTRODUCTION

The SCAM 4x4 transfer gear box attaches to the transmission and connects to both the front and rear drives axles of this four-wheel drive vehicle.

It routes torque from the transmission to both the front and rear axles.

It is equipped with synchronized clutch for high and normal speed and with satellite reduction gear for high and low speed (ON / OFF Road)

The lubricant specified for this transfer gear box is 80 W 90 type and oil capacity is 4.5 litre. (see also the Maintenance sheet)

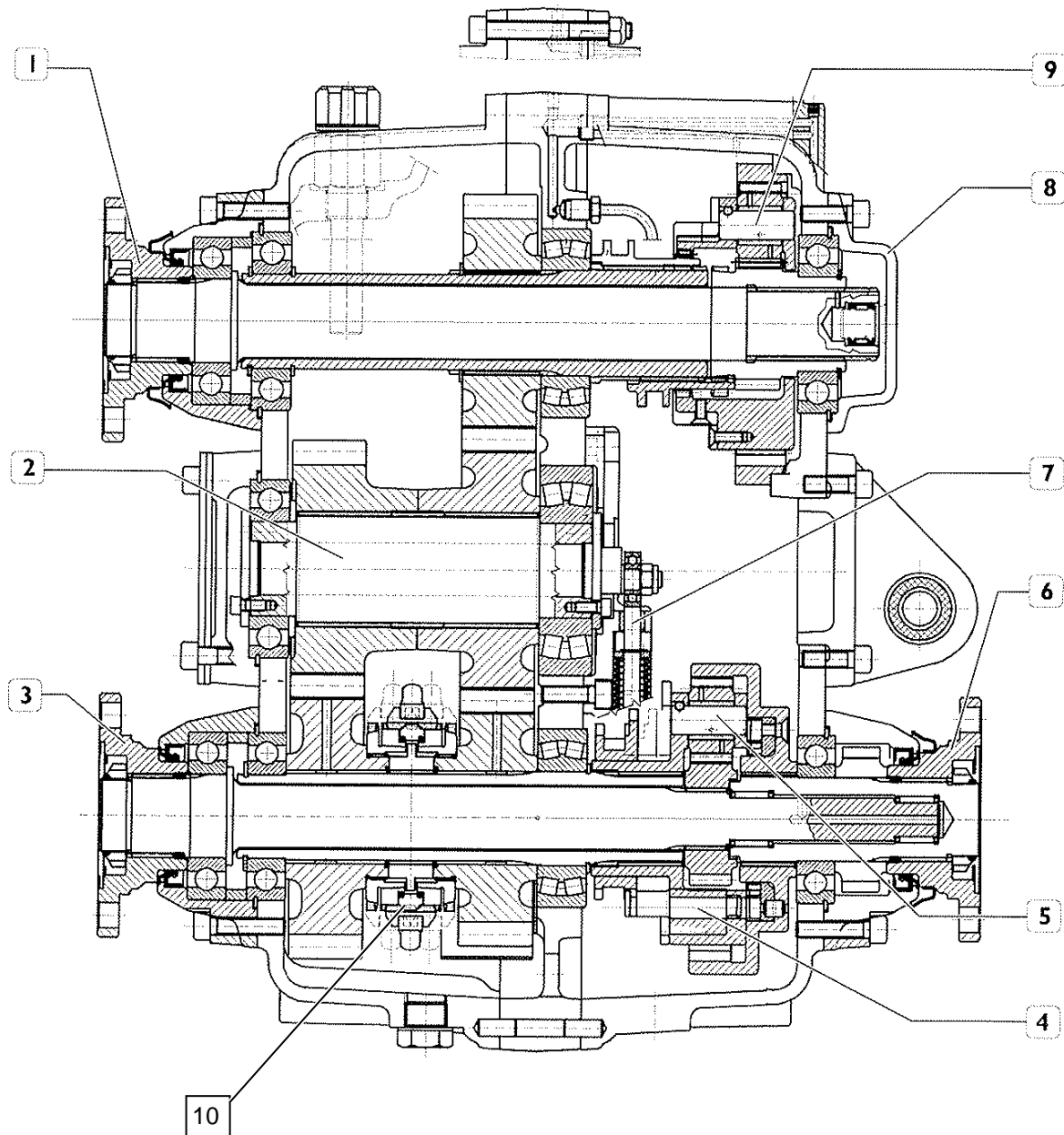

- | | | | |
|---|-------------------------------|----|---------------------------------------------------------------|
| 1 | Upper front shaft with flange | 7 | Oil pump for greasing |
| 2 | Intermediate shaft | 8 | PTO cover |
| 3 | Lower front shaft with flange | 9 | Satellite reduction gear for high and low speed (ON/OFF Road) |
| 4 | Differential locking unit | 10 | Synchronized clutch for high and normal sp |
| 5 | Satellite differential | | |
| 6 | Lower rear shaft with flange | | |